

Notes:  
 1 - To be read with CDM Risk Register.  
 2 - Do not scale, check this is the latest version, if in doubt, ask.  
 3 - See drawing issue log for issue history.

External Materials:  
**Public Square and Access Road -**  
 Marshalls Mistral textured paving with  
 Marshalls Caithness Riven Stone feature bands.  
 Facing Brickwork walls to Feature Landscaping and  
 Marshalls Conservation Kerbs to edging.  
 Marshalls Sineu Graff Bollards to Access Road/Public Square.

Office Car Parking:  
 Road - Marshalls Keyblok Grey with Charcoal markings.  
 Pedestrian Routes - Keyblok Grey with Charcoal markings.  
 Parking Spaces - Keyblok Charcoal with Grey Markings.  
 Paving - Marshalls Riatta.  
 Marshalls Conservation Kerbs to edging.  
 Disable Logo's - Marshalls Colourtop White Keybloks.

Notes:  
 1 - Keybloks to be laid stretcher bond with 200mm soldier course to perimeter.  
 2 - Refer to Landscape Architect Drawings for Landscaping Design.  
 3 - Refer to Engineers Drawings for external works details.

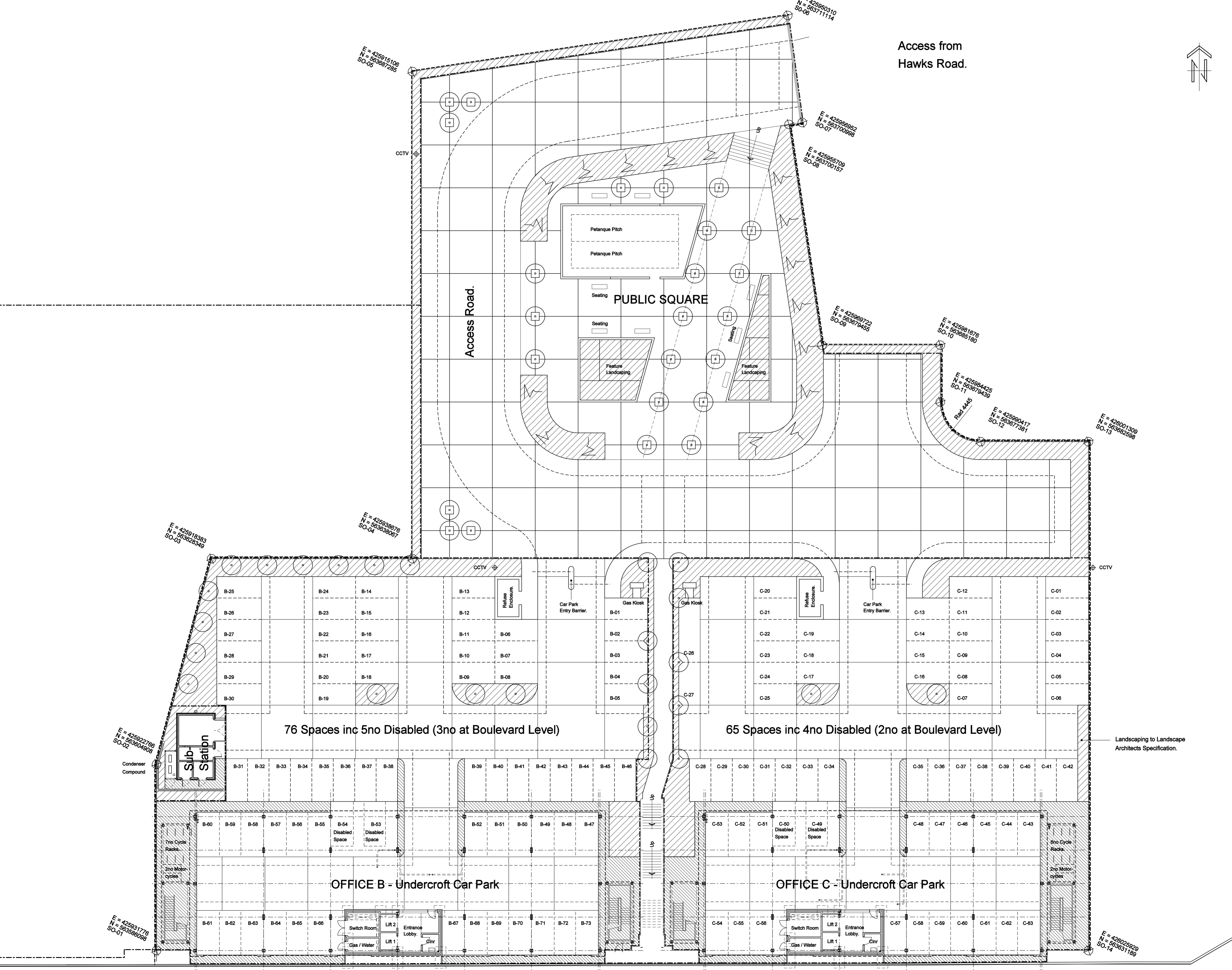
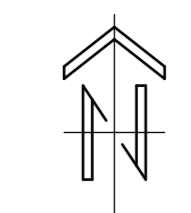

P	CONDENSER COMPOUND INDICATED.	R	18.03.10	MD	-
N	RECORD DRAWING.	R	30.06.08	MD	-
DESIGN		DATE		CLIENT	REVISION

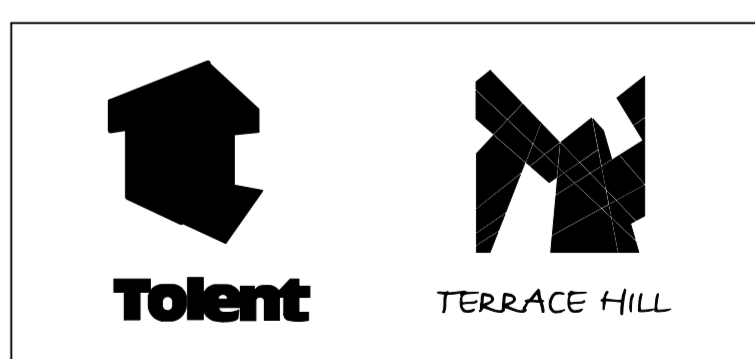

**redboxarchitecture**  
 Red Box Architecture, 1 Pioneer Court, Morton Palms, Darlington, DL1 4WB  
 t: +44 (0)1225 373188, f: +44 (0)1225 373189, mail@redboxdesign.com, www.redboxdesign.com  
 redboxdesigngroup | redboxinteriors | redboxgallery

Project: **Baltic Business Quarter Phase 1 Offices B and C**

Drawing: **GENERAL ARRANGEMENT Proposed Site Plan**

Scale	1:200	Job no.	04 080	Draw no.	
Sheet	A1	Status	Record	102	P

copyright © Red Box Design Group Ltd 2008